

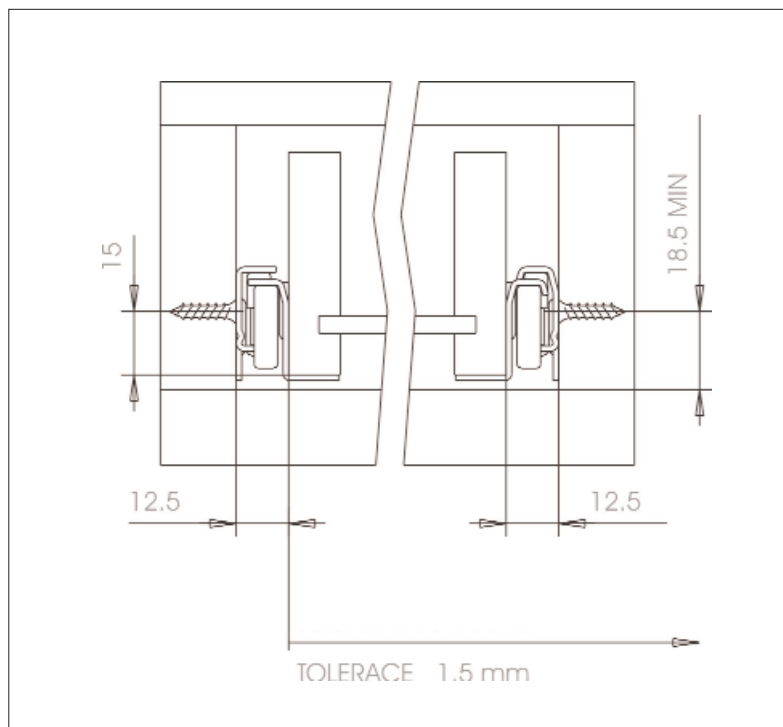

- Self-closing drawer slides
- Double stop
- Load capacity: 25kg
- Thickness: 1 - 1,2mm
- Lengths available: from 250 to 600mm

Mounting instructions



Ferrari hold the right to alter or amend any technical or structural specifications at any time without notice

ITALY

Agostino Ferrari S.p.a.
I - 23878 Verderio S. (LC) Via per Cornate
Tel. ++39.039.59001 - Fax ++39.039.5900222
Web Site://www.ferrarispa.it - e-mail: ferrarispa@ferrarispa.it

U.S.A.

Ferrari America INC.
4189 Eagle Hill Drive - Suite 110 - High Point - North Carolina - 27265 - U.S.A.
Tel. 001 336 8411445 - Fax 001 336 8413543
Web Site://www.ferrariamerica.com - e-mail: info@ferrariamerica.com

GREECE

Ferrari Greece LTD
101 Syngrou Avenue - 11745 Athens -Greece
Tel. 0030 210 9211838 - Fax 0030 210 9211836
e-mail: ferrarinikos@internet.gr

GERMANY

Agostino Ferrari Germany GMBH
Im Meisenfeld 5 - 32602 Vlotho - Exter Germany
Tel. 0049 5228 96080 - Fax 0049 5228 960824
Web Site://www.ferrari-fittings.de - e-mail: ferrari@ferrari-fittings.de

U.K.

Agostino Ferrari (UK) LTD Units H & L
Strawberry Street Industrial Estate HU9 1EN Hull East Yorkshire - U.K.
Tel. 0044 1482 594450 - Fax 0044 1482 594455
Web site://www.aferrariuk.com - e-mail: info@aferrariuk.com

Fixing systems

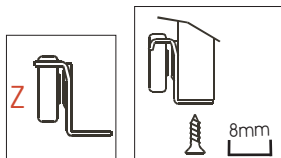
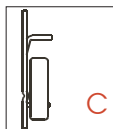

3.5x13mm woodscrews
or 8mm staples

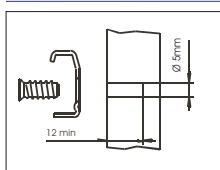

Euroscrews 6.3x13mm

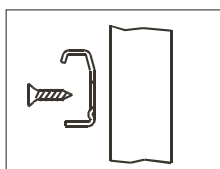

3.5x13mm woodscrews

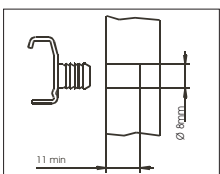

Knock-in by premounted \varnothing 8mm
dowels (T). \varnothing 10mm on request

With thickness 1.2mm

| Length | Code | Extension |
|--------|-----------|-----------|
| 250mm | GS250TV** | 166mm |
| 300mm | GS300TV** | 216mm |
| 350mm | GS350TV** | 266mm |
| 400mm | GS400TV** | 316mm |
| 450mm | GS450TV** | 355mm |
| 500mm | GS500TV** | 398mm |
| 550mm | GS550TV** | 448mm |
| 600mm | GS600TV** | 498mm |

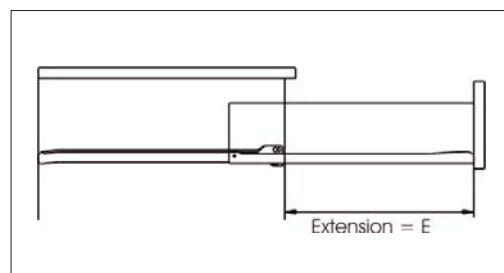

With thickness 1mm

| Length | Code | Extension |
|--------|-----------|-----------|
| 250mm | GS250SV** | 166mm |
| 300mm | GS300SV** | 216mm |
| 350mm | GS350SV** | 266mm |
| 400mm | GS400SV** | 316mm |
| 450mm | GS450SV** | 355mm |
| 500mm | GS500SV** | 398mm |
| 550mm | GS550SV** | 448mm |
| 600mm | GS600SV** | 498mm |

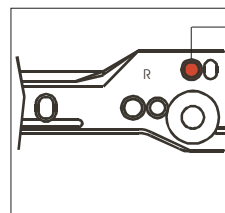

In case of heavy load fix
an additional screw in the
stated position.

Key **

| Set finishing | | |
|---------------|----------|-------|
| 1 | RAL 9001 | White |
| F | RAL 9005 | Black |
| D | RAL 8017 | Brown |

| Packing | |
|---------|------------|
| I | Industrial |
| S | 25 set |
| P | Single set |

Ferrari hold the right to alter or amend any technical or structural specifications at any time without notice

ITALY
Agostino Ferrari S.p.a.
I - 23878 Verderio S. (LC) Via per Cornate
Tel. ++39.039.59001 - Fax ++39.039.5900222
Web Site://www.ferrarispa.it - e-mail: ferrarispa@ferrarispa.it

U.S.A.
Ferrari America INC.
4189 Eagle Hill Drive - Suite 110 - High Point - North Carolina - 27265 - U.S.A.
Tel. 001 336 8411445 - Fax 001 336 8413543
Web Site://www.ferrariamerica.com - e-mail: info@ferrariamerica.com

GREECE
Ferrari Greece LTD
101 Syngrou Avenue - 11745 Athens -Greece
Tel. 0030 210 9211838 - Fax 0030 210 9211836
e-mail: ferrarinikos@internet.gr

GERMANY
Agostino Ferrari Germany GMBH
Im Meisenfeld 5 - 32602 Vlotho - Exter Germany
Tel. 0049 5228 96080 - Fax 0049 5228 960824
Web Site://www.ferrari-fittings.de - e-mail: ferrari@ferrari-fittings.de

U.K.
Agostino Ferrari (UK) LTD Units H & L
Strawberry Street Industrial Estate HU9 1EN Hull East Yorkshire - U.K.
Tel. 0044 1482 59450 - Fax 0044 1482 59455
Web site://www.aferrariuk.com - e-mail: info@aferrariuk.com

T = FERRARI STANDARD DOWELS POSITION
(WHEN REQUIRED)

PROVVISORIO

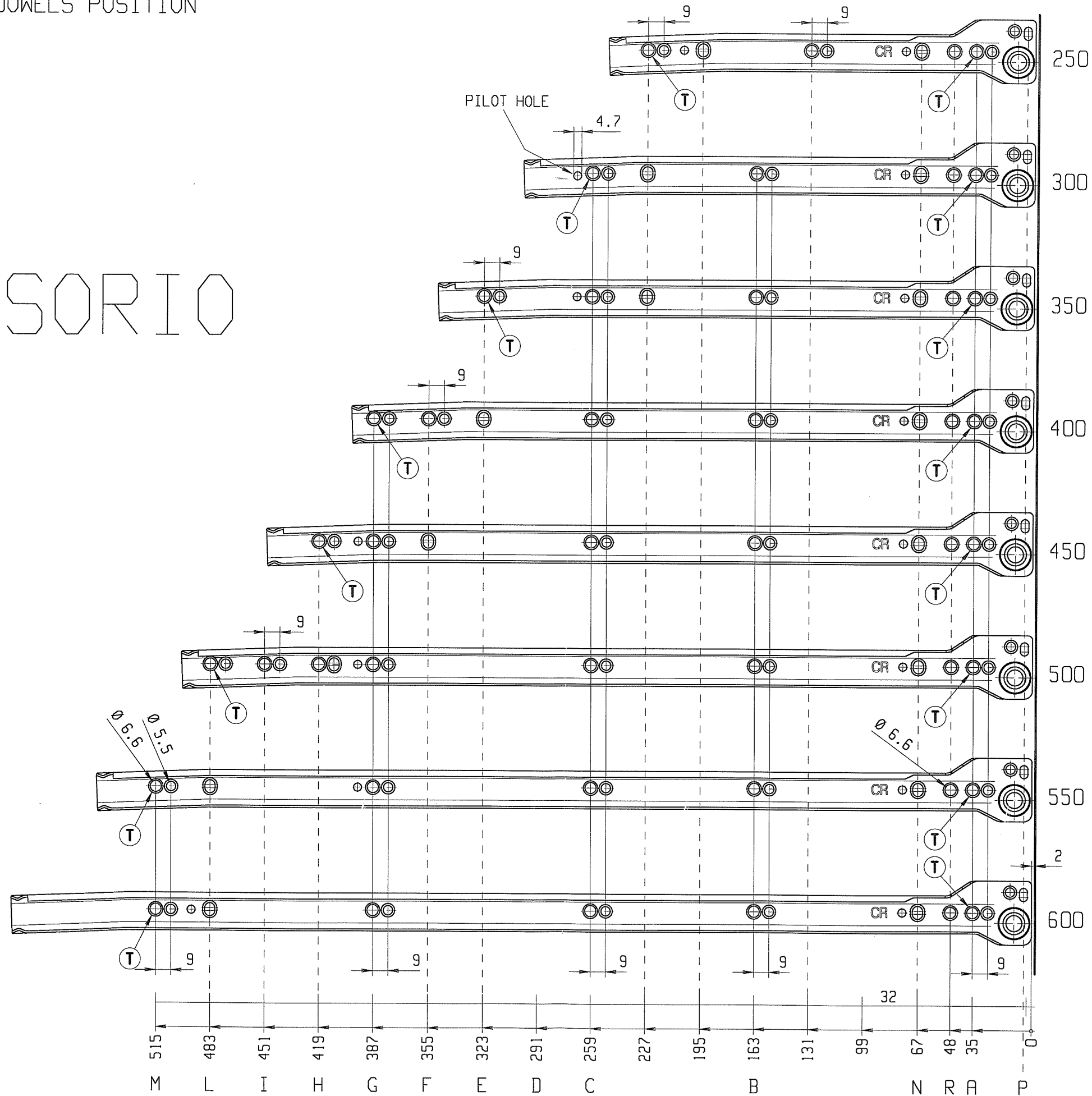

| | | | |
|--|------|----------|-------|
| 19/03/04 | DATA | FIRMA | VISTO |
| AGGIUNTI FORI A 48 , PER L=500 AGGIUNTI FORO E ASOLA A 419 | | MODIFICA | |
| C | N | | |

ferrari
AGOSTINO FERRARI S.p.A.

Codice FSG014

data 03/12/01 scala 1:2.5 rev. C
dis. *Colombo* commessa.

ECO SLIDES: SKETCH FOR CR/CL PROFILES

SGS2L600

SGS2L550

SGS2L500

SGS2L450

SGS2L400

SGS2L350

SGS2L300

SGS2L250

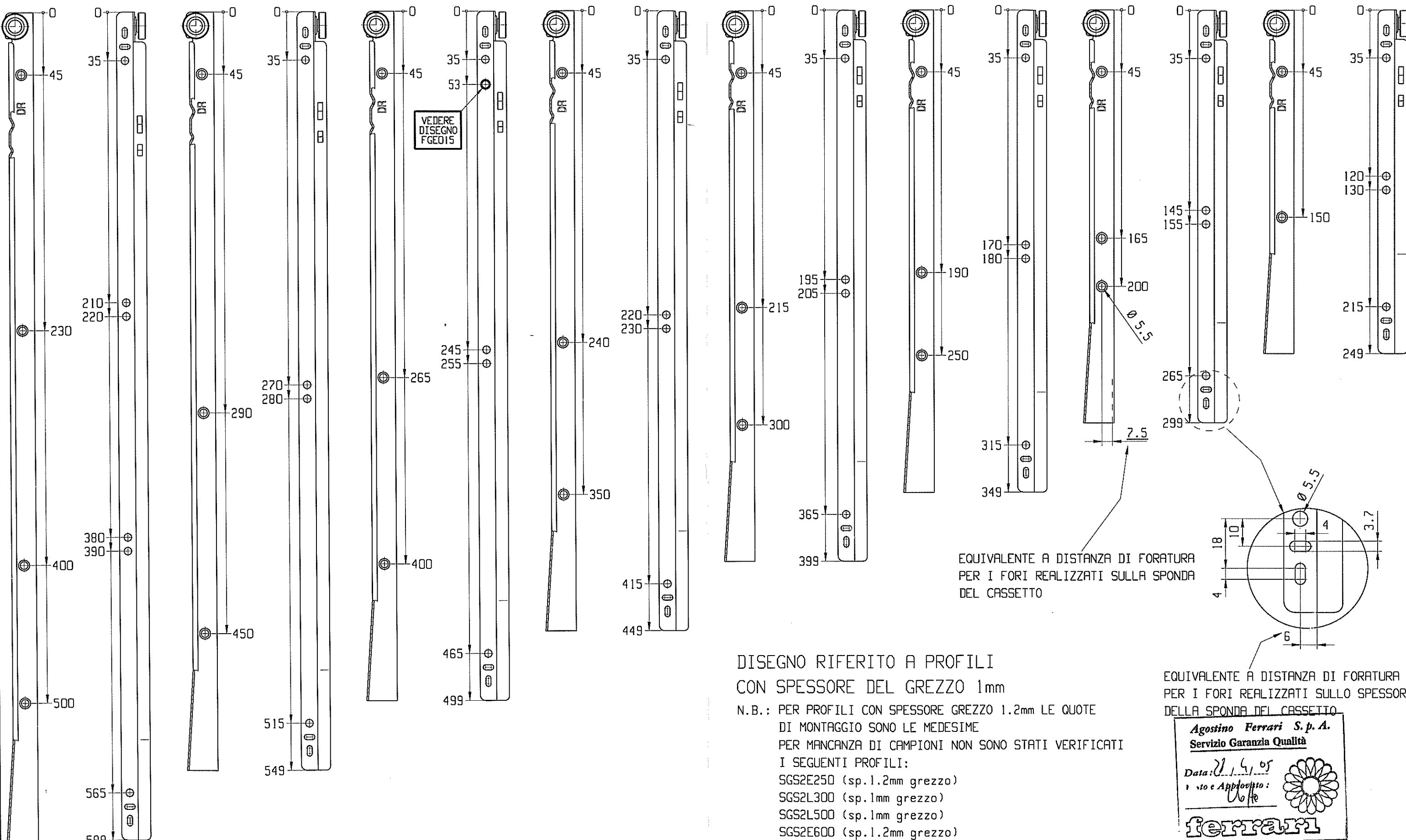

VEDERE DISEGNO FGE015

EQUIVALENTE A DISTANZA DI FORATURA PER I FORI REALIZZATI SULLA SPONDA DEL CASSETTO

EQUIVALENTE A DISTANZA DI FORATURA PER I FORI REALIZZATI SULLO SPESSORE DELLA SPONDA DEL CASSETTO

DISEGNO RIFERITO A PROFILI CON SPESSORE DEL GREZZO 1mm

N.B.: PER PROFILI CON SPESSORE GREZZO 1.2mm LE QUOTE DI MONTAGGIO SONO LE MEDESIME PER MANCANZA DI CAMPIONI NON SONO STATI VERIFICATI I SEGUENTI PROFILI:

- SGS2E250 (sp.1.2mm grezzo)
- SGS2L300 (sp.1mm grezzo)
- SGS2L500 (sp.1mm grezzo)
- SGS2E600 (sp.1.2mm grezzo)

Agostino Ferrari S.p.A.
 Servizio Garanzia Qualità
 Data: 21/4/05
 Disegnato e Approvato: [Signature]
 ferrari